

# Welcome! Today's session will start shortly.

Before the session starts, please reflect on the following questions and share your responses by typing into the text chat box...

Where in the  
world are you  
joining us from  
today?

What would you  
like to study?

Why are you  
considering  
Edinburgh?



THE UNIVERSITY  
of EDINBURGH

**EDINBURGH**  
extraordinary futures await

# Welcome live and direct from Edinburgh!



- Audio Check
- Recording of the session
- The city and the country
- The University
- Postgraduate study
- Graduate Q&A at various points
- Next Steps



THE UNIVERSITY  
of EDINBURGH

**EDINBURGH**  
extraordinary futures await

# Audio check

- Can you hear the presenter speaking?
- Please type “no” in the Chat area if you cannot hear the presenter

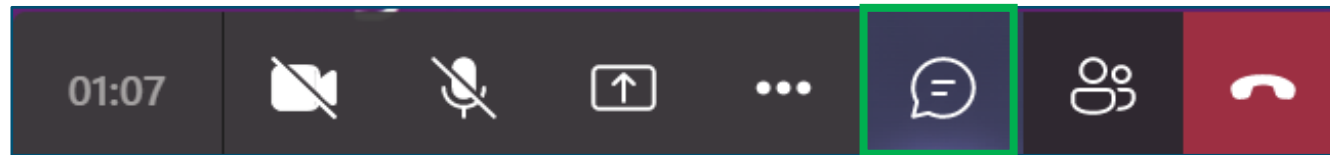

- If you can't hear:
  - Check your settings by clicking on the three little dots on the options bar and then 'show device settings'. Here you can check and change your speakers.
  - Try signing out and signing back into the session
  - Don't worry, the session is being recorded

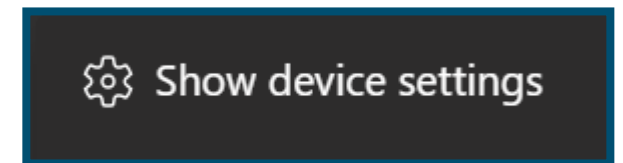

# Live captions

You can turn on automated live captions as follows:

- More > Language and speech > Turn on live captions
- These are automated therefore won't be 100% accurate
- Please DO NOT CHANGE language (as this impacts recording captions)

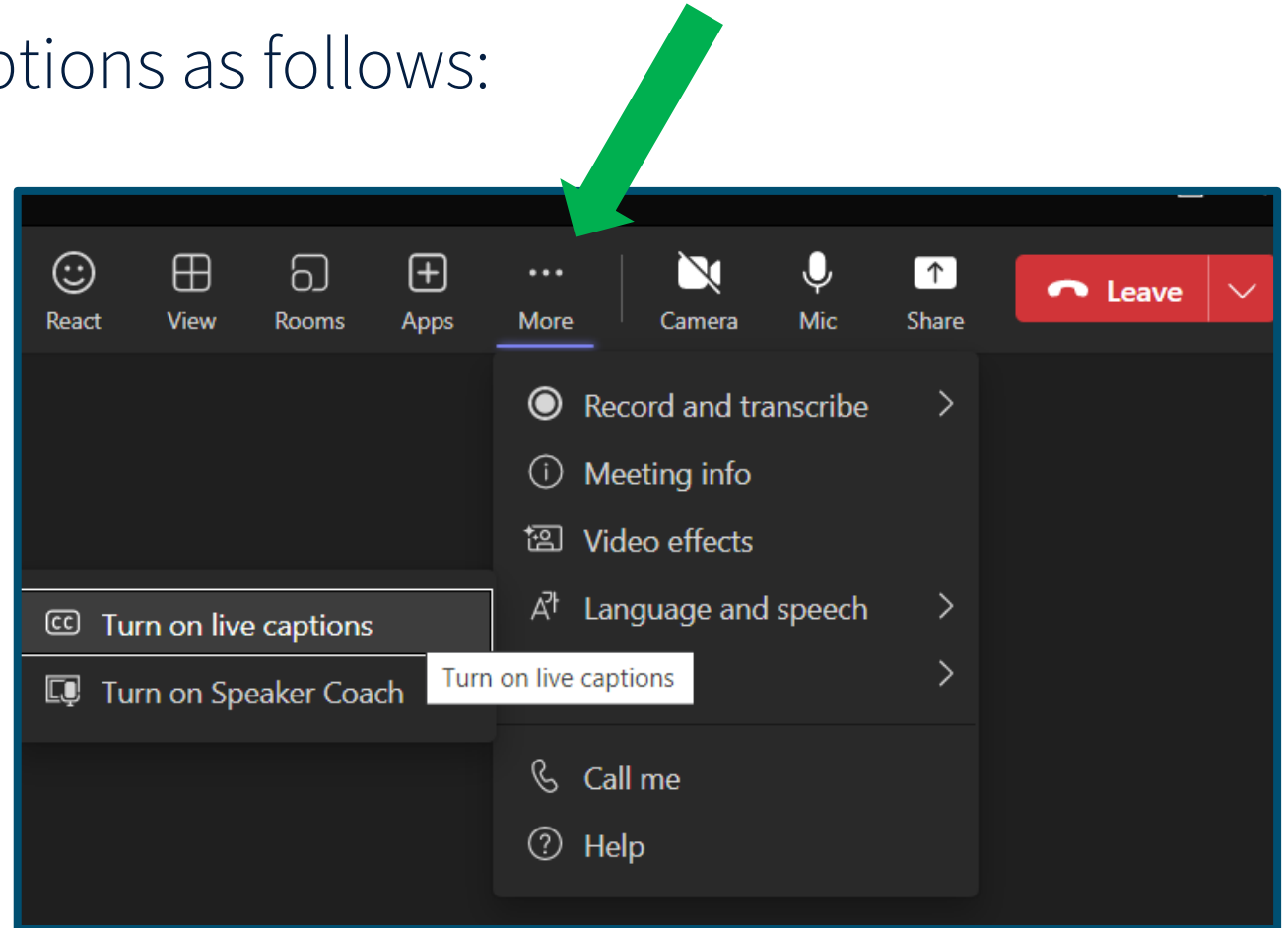



# Asking questions

- Use **Chat** for comments
- Use **Q&A** for questions

If we don't manage to answer,  
please email  
[futurestudents@ed.ac.uk](mailto:futurestudents@ed.ac.uk)

## Desktop

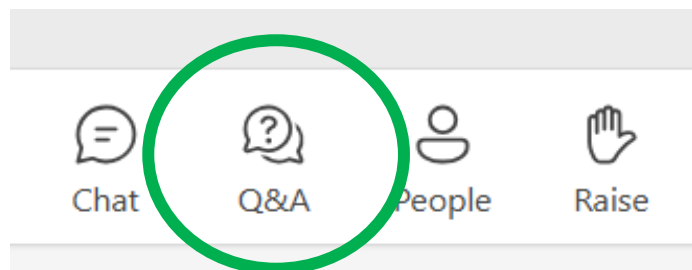

## Mobile

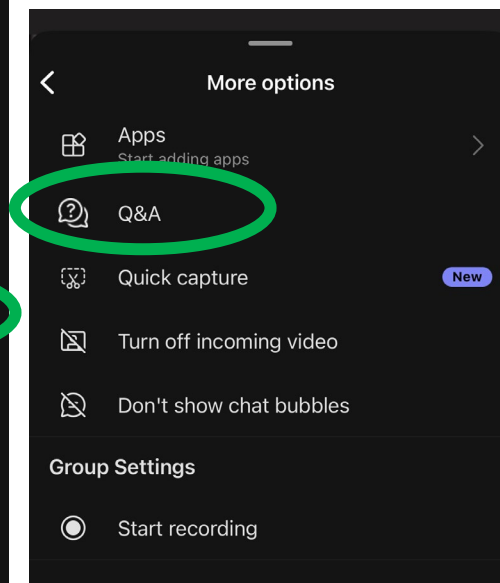
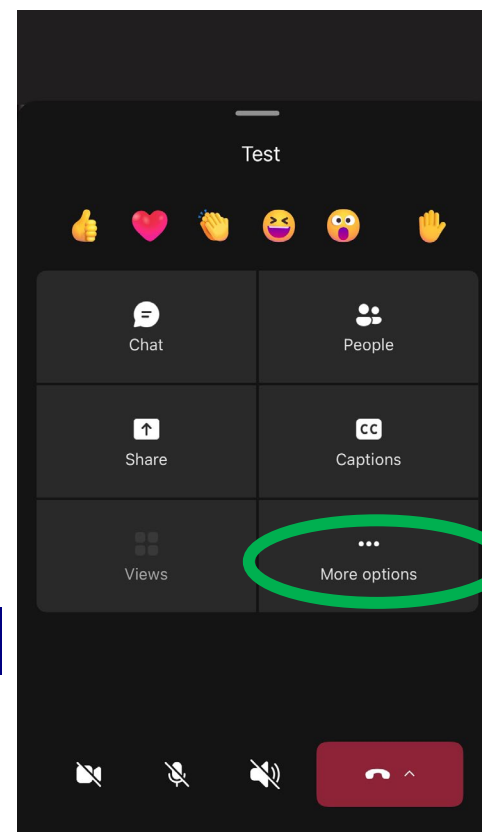
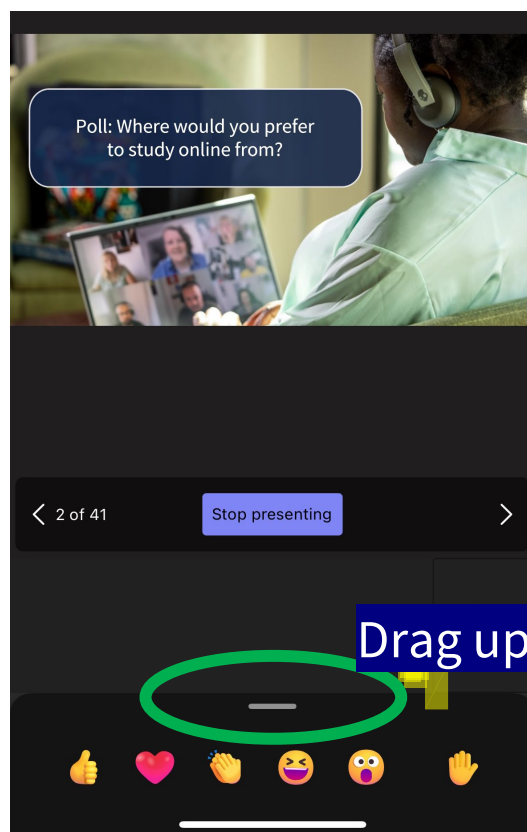

# What is your connection to Scotland?

I live in Scotland

I have visited before

I have not been yet, but would like to

I plan to study online from outside Scotland



THE UNIVERSITY  
of EDINBURGH

**EDINBURGH**  
extraordinary futures await

# Why do you want to study a postgraduate degree?

Personal interest / passion

Pursuing research (e.g., PhD)

To enter or change fields / professions

To progress in my chosen career

Other



# Recording

- This session is being recorded
- Your name should not appear in the recording
- Any information that you provide during the session is optional and in doing so you give us consent to process this information
- If you don't want your question read out in public, you can email your question to [futurestudents@ed.ac.uk](mailto:futurestudents@ed.ac.uk)
- The session will be stored by the University of Edinburgh and published on our website after the event on a non-indexed web page
- You will be emailed with a link to watch the session recording by the end of this week







THE UNIVERSITY  
*of* EDINBURGH

An aerial photograph of the University of Edinburgh campus, showing a mix of modern glass-fronted buildings and traditional stone architecture. A large green park area is visible in the upper center. A semi-circular plaza with a circular fountain is in the lower center. The text 'INTRODUCTION TO Postgraduate Study AT THE UNIVERSITY OF EDINBURGH' is overlaid in a dark blue box in the center.

# INTRODUCTION TO Postgraduate Study AT THE UNIVERSITY OF EDINBURGH

September 2025

**EDINBURGH**  
extraordinary futures await



# Welcome to today's graduate...



THE UNIVERSITY  
*of* EDINBURGH

**EDINBURGH**  
extraordinary futures await



# Introducing **Scotland**

A distinctive culture and country of contrasts

- Steeped in history but modern and progressive
- Picturesque countryside - busy, lively cities
- Population of 5.4 million
- Well-connected to major UK cities, Europe and the rest of the world
- Hospitable and welcoming



THE UNIVERSITY  
of EDINBURGH

**EDINBURGH**  
extraordinary futures await





## World-class city

Large enough to offer something for everyone, small enough to feel like home

- Scotland's capital, an irresistible blend of history, natural beauty and modern city life
- Friendly and diverse multicultural community
- World famous cultural hub, Festival City
- Abundance of parks and green spaces
- Compact and walkable



THE UNIVERSITY  
of EDINBURGH

**EDINBURGH**  
xtraordinary futures await

# Living and studying in Scotland / Edinburgh

What's it like to live and study here?



THE UNIVERSITY  
of EDINBURGH

**EDINBURGH**  
extraordinary futures await



# The University in the city

 = University buildings

 = City landmarks

 = Park spaces

 5-minute walk

 15-minute walk





# Asking questions – quick reminder

- Use **Chat** for comments
- Use **Q&A** for questions

If we don't manage to answer,  
please email  
[futurestudents@ed.ac.uk](mailto:futurestudents@ed.ac.uk)

## Desktop

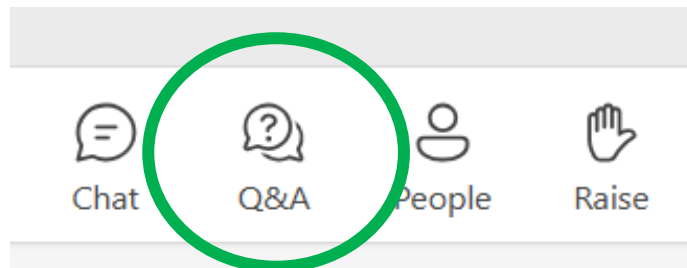

## Mobile

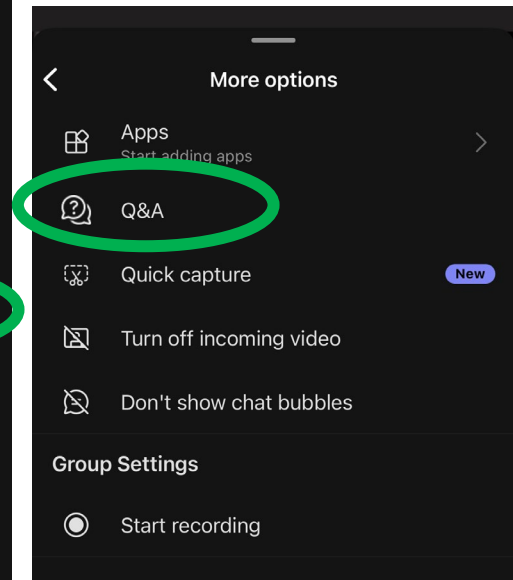
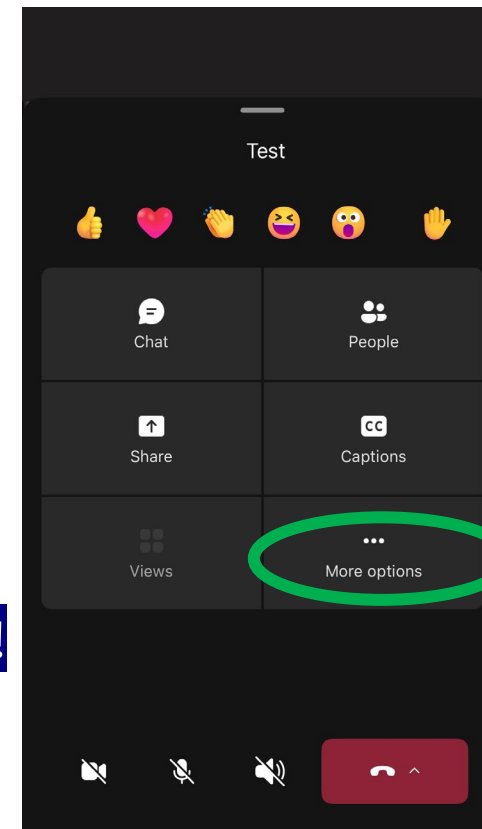
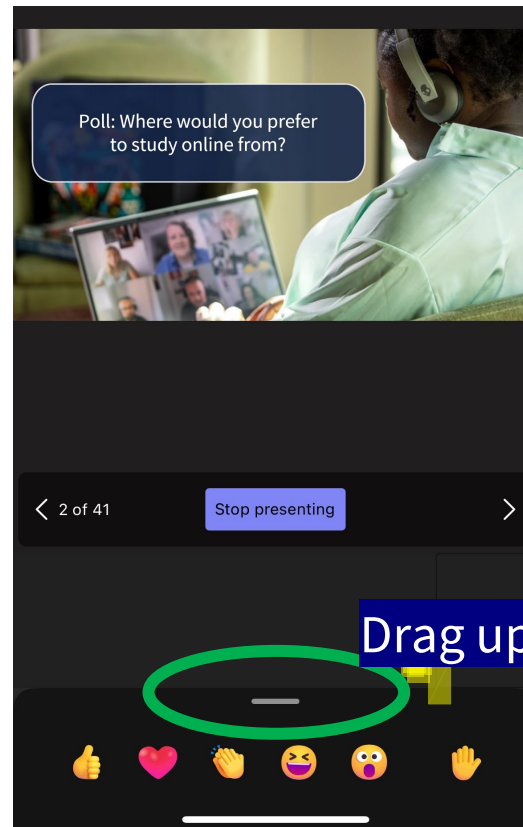



# World-leading University

- Experience the very best in teaching, research and innovation in the Arts, Humanities, Social Sciences, Medicine, Veterinary Medicine, Science and Engineering
- We equip you with the skills, insights and perspectives to enhance your employability and build a successful future



THE UNIVERSITY  
of EDINBURGH

**EDINBURGH**  
xtraordinary futures await





# Modern and progressive

At the forefront of intellectual and technological advances, making the world a better place

- Innovative degree programmes that respond to global challenges
- Committed to sustainability – we're going **carbon neutral** and **zero waste** by 2040
- £1.5bn investment in our teaching and learning, sports and research facilities
- The transformative interdisciplinary Edinburgh Futures Institute has now opened its doors at its stunning new home



THE UNIVERSITY  
of EDINBURGH

**EDINBURGH**  
extraordinary futures await





# Academic structure

## Colleges, Schools and programmes

3 large Colleges reflect our main areas of teaching and research

- Arts, Humanities & Social Sciences
- Medicine & Veterinary Medicine
- Science & Engineering

21 Schools group together our subject experts, support staff, students and facilities

## Academic Programmes

- 300+ Postgraduate taught programmes
- 135 Research areas covering wide range of academic disciplines



THE UNIVERSITY  
of EDINBURGH

**EDINBURGH**  
extraordinary futures await

## College of Arts, Humanities & Social Sciences (CAHSS)

### 12 Schools

- Business
- Divinity
- Economics
- Edinburgh College of Art
- Education
- Health in Social Science
- History, Classics and Archaeology
- Law
- Literatures, Languages and Cultures
- Philosophy, Psychology & Language Sciences
- Social and Political Science

## College of Medicine & Veterinary Medicine (CMVM)

### 2 Schools

- Edinburgh Medical School:
  - Biomedical Sciences
  - Clinical Sciences
  - Molecular, Genetic and Population Health Sciences
- Royal (Dick) School of Veterinary Studies

## College of Science & Engineering (CSE)

### 7 Schools

- Biological Sciences
- Chemistry
- Engineering
- Geosciences
- Informatics
- Mathematics
- Physics & Astronomy

A purple circle containing the text "Edinburgh Futures Institute" in white.

Edinburgh  
Futures  
Institute



# Finding information about the University/programme

What tips would you give for finding information you need?







Why pursue a  
postgraduate degree?



# Why study a postgraduate degree?

What were your  
motivations for pursuing  
postgraduate study?



THE UNIVERSITY  
of EDINBURGH

**EDINBURGH**  
extraordinary futures await



# Postgraduate degrees

## Taught and research

**Taught degrees, 12 months full time\*\*** most programmes

MA, MSc, MBA, MEd, MMus, MTheol, LLM

Curriculum driven experience, culminating in a period of independent work submitted as a dissertation

## Research degrees

**MSc by Research – 1 year**

More individual, research-driven approach to chosen subject, preparation and training for advanced PhD research

**MPhil – 2 years**

Advanced research qualification, assessed by thesis

**PhD – 3 years**

Highly specialised independent research training culminating in submission of thesis



THE UNIVERSITY  
of EDINBURGH

**EDINBURGH**  
xtraordinary futures await





# Edinburgh Taught Masters

Highly intensive, typically 12 months of full-time study

- Two 10-week semesters culminating in a dissertation over the summer
- Mix of core and optional courses, often including opportunity for interdisciplinary study
- Independent project or dissertation to build on your interests (typically May – August)
- PG Certificate/Diplomas offer a vocational programme to build your skillset
- Preparation for further research
- Stimulating and supportive postgraduate community
- Links with industry and professional networking opportunities



THE UNIVERSITY  
of EDINBURGH

**EDINBURGH**  
extraordinary futures await





# Edinburgh Research degrees

## Intensive period of independent research

- Develop the methodological and technical skills and subject knowledge to contribute to your discipline.
- MScR programmes provide a stepping-stone to research career or PhD study
- Manage your own or an established project with one or more supervisors who are leaders in their fields
- Embrace your academic autonomy whilst belonging to a supportive and collegiate community
- Access to cutting-edge facilities and transferable skills training



THE UNIVERSITY  
of EDINBURGH

**EDINBURGH**  
xtraordinary futures await





# Careers and employability

Employers from all sectors regard Edinburgh as an excellent training ground for high-flyers

- One of the top universities targeted for recruitment
- Employers value our graduates for their intellectual ability and high-level attributes developed while studying here
- Graduate Route visa – stay back in UK for 2 years after graduation



THE UNIVERSITY  
of EDINBURGH

**EDINBURGH**  
xtraordinary futures await

# Asking questions

Type your question in the **Q&A** (not Chat), and we'll do our best to answer as many as we can.

If we don't manage to answer, please email [futurestudents@ed.ac.uk](mailto:futurestudents@ed.ac.uk)

## Desktop

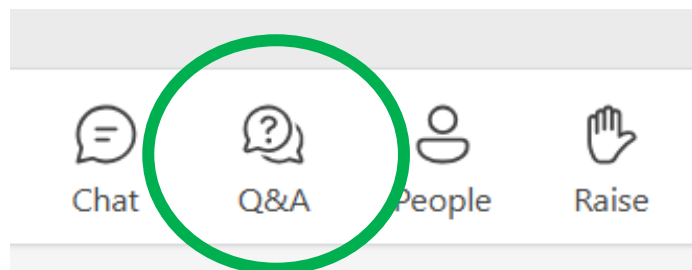

## Mobile

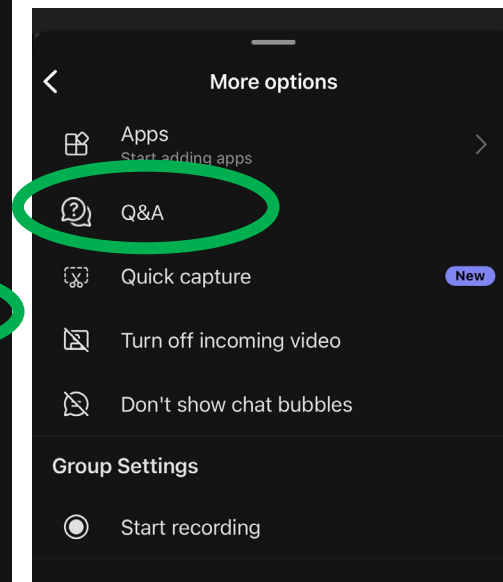
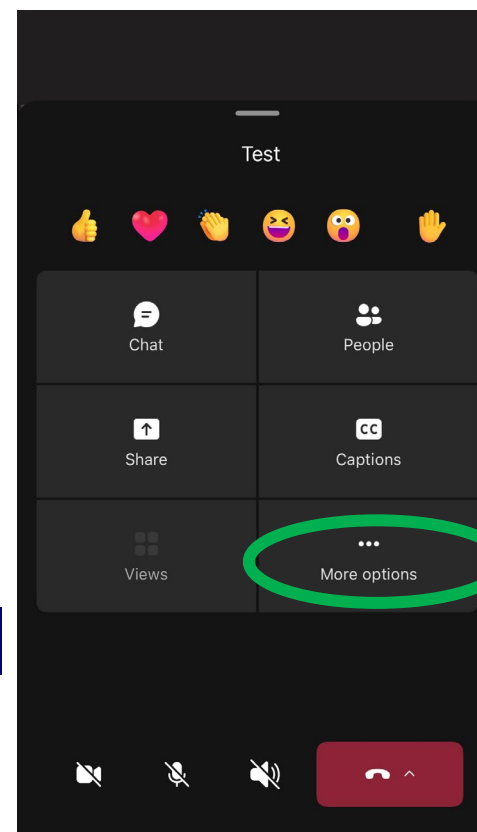
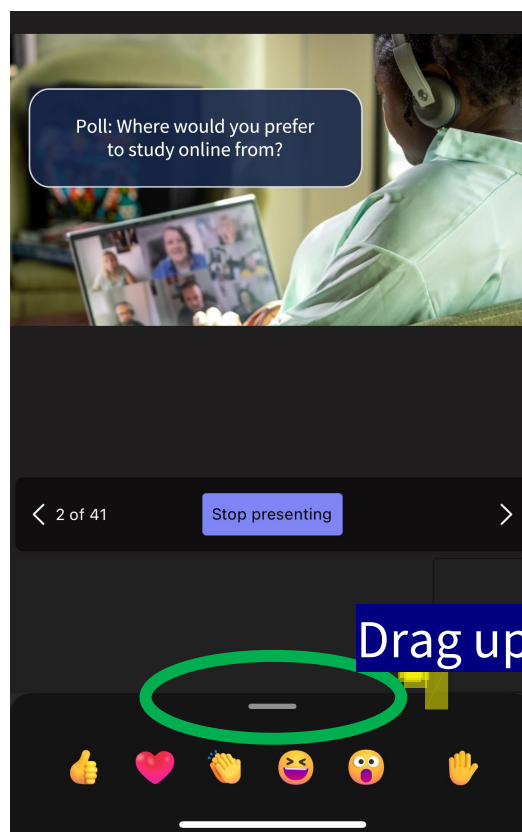





# Applying to Edinburgh

Wide range of qualifications recognised for entry

- Accepted qualifications for entry listed for every programme in [Degree Finder](#)
- Entry is competitive, but varies between programme
- Courses in high demand likely require higher entry grades
- Check for non-academic entry requirements such as work experience, interviews, portfolio
- Asylum & Refugee status



THE UNIVERSITY  
of EDINBURGH

**EDINBURGH**  
extraordinary futures await



# Applying to the University

What are your top tips for  
applying and being successful in  
your application?



# How to apply

Check our degree finder for full programme and contact details

Check subject-specific entry requirements and identify funding for which you're eligible

Prepare your personal statement and request an academic reference

PhD applicants only: Identify a supervisor and prepare your research proposal

Submit application before the deadline!



THE UNIVERSITY  
of EDINBURGH

**EDINBURGH**  
extraordinary futures await



# Costs and funding

**Varies by programme and fee status**

- Check website or up-to-date information on course fees and any additional programme costs
- Recommended budget of £1,500 per month for living costs
- Check with national funding bodies, UK student apply to local funding body for loan/grants
- Merit-based scholarships available for a limited number of programmes
- Check your options using Scholarship search tool <https://www.ed.ac.uk/student-funding/search-scholarships>



THE UNIVERSITY  
of EDINBURGH

**EDINBURGH**  
extraordinary futures await



# Affording and paying for postgraduate study

What are your top tips for funding and budgeting?





# Student experience

World-class facilities and award-winning support services

- Dedicated academic and student experience support from your School
- Peer to peer learning networks
- Extensive range of services to support your physical and mental wellbeing
- Over 350 societies covering a vast range of interests
- IT, Library & eLearning help available 24/7
- One of the UK's leading sports universities, world class sports facilities



THE UNIVERSITY  
of EDINBURGH

**EDINBURGH**  
extraordinary futures await





THE UNIVERSITY  
of EDINBURGH

# Accommodation / Housing

## University Accommodation

- <https://www.accom.ed.ac.uk>

## Private Accommodation

- <https://edin.ac/2WB6o88>

## Neighbourhoods

- <https://edin.ac/42ycZ0k>

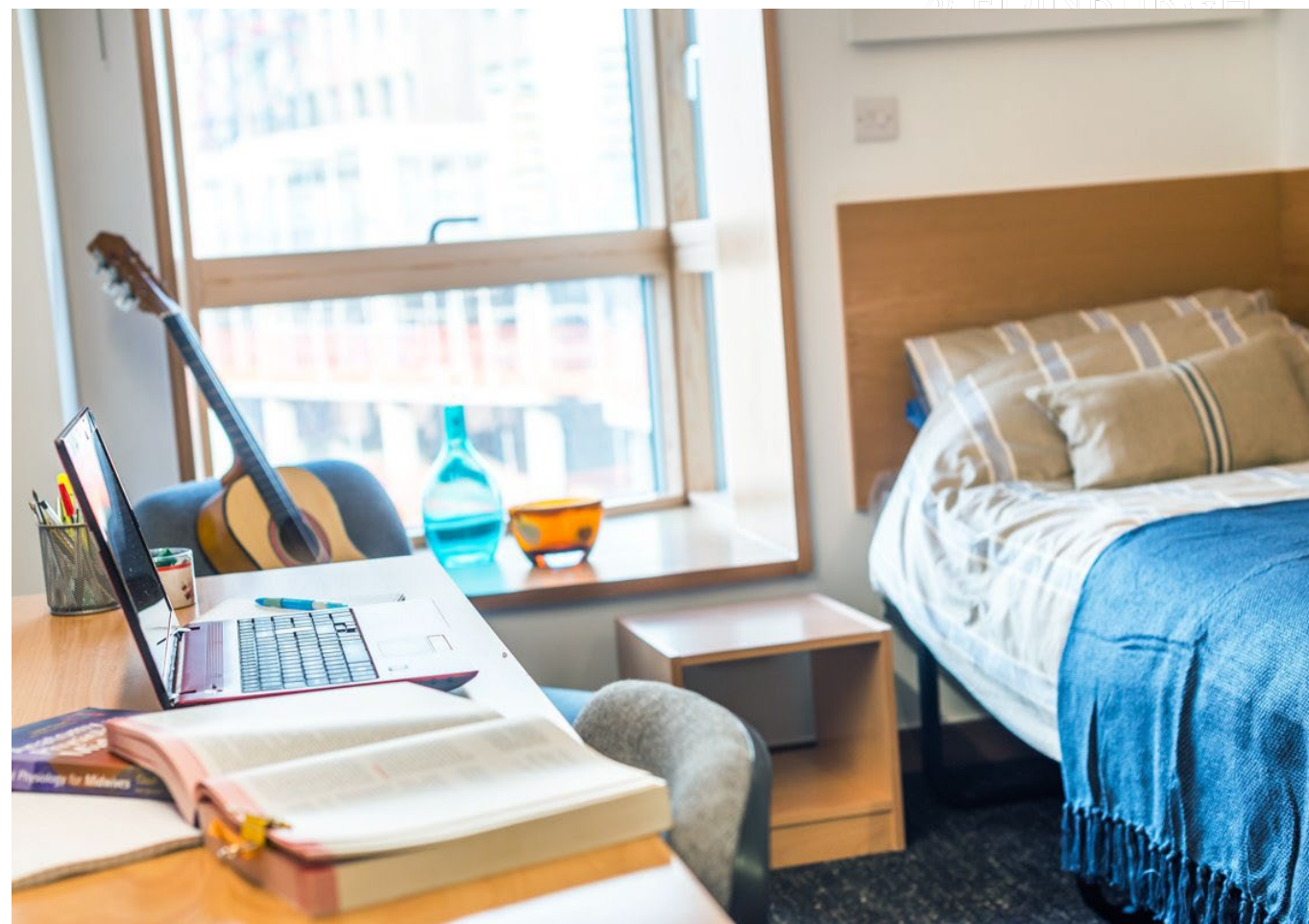

THE UNIVERSITY  
of EDINBURGH

**EDINBURGH**  
extraordinary futures await



# Student support

What is your experience of student services, support and facilities?



# Did you get the info you were looking for?

1. Programme-specific questions:  
<https://edin.ac/2raiG47>
2. Chat to our Students:
  - <https://edin.ac/3nmiU3k>
3. Any other questions (including, Fees & Admissions):
  - Email: [futurestudents@ed.ac.uk](mailto:futurestudents@ed.ac.uk)

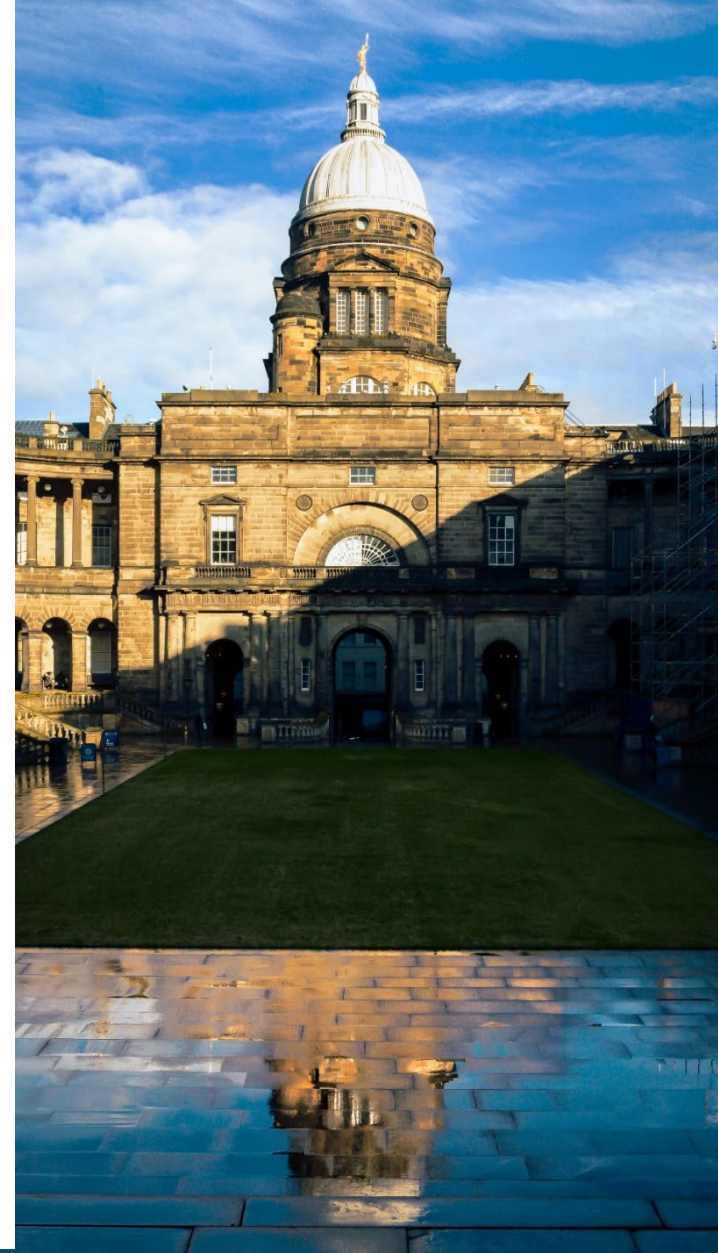

THE UNIVERSITY  
of EDINBURGH

**EDINBURGH**  
extraordinary futures await



# Postgraduate Open Days On-demand

For more  
information:  
[edin.ac/pgodod](https://edin.ac/pgodod)



THE UNIVERSITY  
of EDINBURGH

**EDINBURGH**  
extraordinary futures await



Read our students' blogs at  
[blogs.ed.ac.uk/studentstories](https://blogs.ed.ac.uk/studentstories)



THE UNIVERSITY  
of EDINBURGH

**EDINBURGH**  
extraordinary futures await



We'll email you when registrations open in early October

# Postgraduate Virtual Open Days

19 - 21 November



THE UNIVERSITY  
of EDINBURGH

**EDINBURGH**  
extraordinary futures await

# Before you go....Please help us test our new website

- Introducing Pete Watson,
- User Experience Specialist,
- The University of Edinburgh Prospective Student Web Content Team



THE UNIVERSITY  
*of* EDINBURGH

**EDINBURGH**  
extraordinary futures await



# We want prospective Postgraduate students to test our new website

- **When we want to do it:**

- Between late October – early November

- **Where we will do it:**

- Remotely using MS Teams or Zoom

- **How long it will take:**

- 45 minutes

- **What we will pay:**

- £15 online shopping voucher



# Register your interest in helping us with user research

- Complete the short form if you'd like to take part:

<https://forms.cloud.microsoft/e/B2vRb5qHvT>



THE UNIVERSITY  
of EDINBURGH

**EDINBURGH**  
extraordinary futures await





THE UNIVERSITY  
*of* EDINBURGH

# Thank you

Contact: [futurestudents@ed.ac.uk](mailto:futurestudents@ed.ac.uk)

**EDINBURGH**  
xtraordinary futures await